

Engineering Specification

Job Name _____

Contractor _____

Job Location _____

Approval _____

Engineer _____

Contractor's P.O. No. _____

Approval _____

Representative _____

LEAD FREE*

Series LF3005A Dielectric Unions

Sizes: 1/2" – 3/4"

Series LF3005 dielectric unions feature a male iron pipe thread to solder connection. These unions are designed to be installed between pipe made from dissimilar metals to prevent accelerated corrosion and deterioration in the piping system due to galvanic and stray current. Designed and manufactured to the highest quality standards. Gasket rated to 210°F (99°) at 250psi (17.2 bar). The LF3005A features Lead Free* construction to comply with Lead Free* installation requirements.

Features

- Male iron pipe thread to solder connection
- Designed and manufactured to the highest quality standards
- Factory audit tested to confirm 600V dry line performance without flashover
- Rated to 180°F (82°C) at 250psi (17.2 bar)

Specifications

A dielectric union shall be installed where indicated on the plans. The union shall feature a male iron pipe thread to solder connection. The dielectric union shall be constructed using Lead Free* materials. Inquire with governing authorities for local installation requirements. The dielectric union shall be a Watts Series LF3005A.

Materials — Dimensions — Weights

Call customer service if you need assistance with technical details.

LF3005A



Standards

Meet federal specifications for tensile strength and thread end connections.

Pressure — Temperature

Maximum Pressure: 250psi (17.2 bar)

Maximum Temperature: 180°F (82°C)

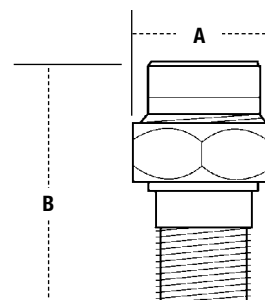

SIZE <i>in.</i>	TAIL PIECE	MATERIALS				DIMENSIONS				WEIGHT	
		ADAPTER †	NUT †	INSULATOR	GASKET	A		B		<i>oz.</i>	<i>gm</i>
						<i>in.</i>	<i>mm</i>	<i>in.</i>	<i>mm</i>		
1/2	Lead Free Brass	Steel	Steel	Polysulfone	Buna-N	1 1/2	38	2 5/8	67	7.5	213
3/4	Lead Free Brass	Steel	Steel	Polysulfone	Buna-N	1 5/8	41	3	76	9	255

† Steel adapter and nut are zinc plated

NOTICE

The information contained herein is not intended to replace the full product installation and safety information available or the experience of a trained product installer. You are required to thoroughly read all installation instructions and product safety information before beginning the installation of this product.

NOTICE

Inquire with governing authorities for local installation requirements

*The wetted surface of this product contacted by consumable water contains less than 0.25% of lead by weight.

Watts product specifications in U.S. customary units and metric are approximate and are provided for reference only. For precise measurements, please contact Watts Technical Service. Watts reserves the right to change or modify product design, construction, specifications, or materials without prior notice and without incurring any obligation to make such changes and modifications on Watts products previously or subsequently sold.

USA: T: (978) 689-6066 • Watts.com

Canada: T: (888) 208-8927 • Watts.ca

Latin America: T: (52) 55-4122-0138 • Watts.com

ES-LF3005A 2534

© 2025 Watts