

Series W-913-16P(DN15-DN80)

Electrical Three-way Control Valve

◆ Application

The Series W-913-16P Electrical Two-way Control Valves are used with Series W-A11 actuators. They are extensively applied to HVAC water systems, boiler systems, heat exchange systems or AHU steam systems to regulate the flow rates of fluids in these systems.

◆ Features

- Equal percentage control characteristic achieves high control precision
- Electronic presetting function facilitates on-site commissioning
- Automatic fault detection and alarm functions
- Overload protection function for the power supply

◆ Operating Principles

Once the valve's actuator receives the control signal from the BA System, it will regulate the valve's opening rate by moving the valve stem, and thus change the system's flow rate.

◆ Technical specification

Dimensions:	DN15-DN80
Working Temperature:	-25~150°C
Working Pressure:	PN16
Fluid Medium:	Water / Ethylene Glycol / Propylene Glycol
Connection:	Threaded Connection
Connection Standard:	ISO 7/1
Flow Deviation:	±5%
Function:	Three-way Mixing / Diverting Control
Control Characteristic:	Equal Percentage
Leak Rate:	≤ 0.02% Kvs

Materials:

-Valve Body:	Stainless Steel
-Valve Core:	Stainless Steel
-Valve Stem:	Stainless Steel
-Spring:	Stainless Steel
-Sealing:	PTFE

◆ Technical Parameters

Product Type:

Type	Size	Kvs	Stroke (mm)	Actuator Force(N)	Shutoff ΔP (KPa)
W-913AW015-16P	DN15	1.9	10	500N	≤500
W-913AW020-16P	DN20	4.4	10	500N	≤500
W-913AW025-16P	DN25	8	15	500N	≤400
W-913AW032-16P	DN32	10	20	500N	≤350
W-913AW040-16P	DN40	20	20	500N	≤300
W-913BW050-16P	DN50	32	20	1000N	≤300
W-913BW065-16P	DN65	50	20	1000N	≤250
W-913BW080-16P	DN80	66	20	1000N	≤250

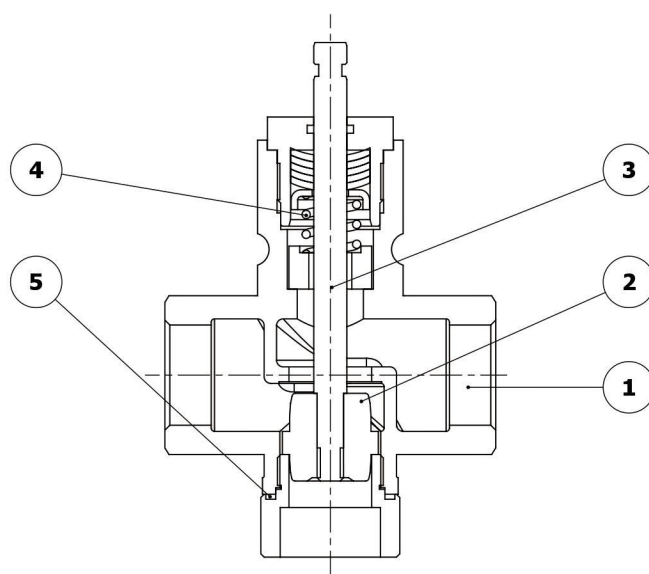

Coding Rules:

W	WATTS	W	9	1	3	A	W	0	15	-	16	P
9	Electronic											
1	Threaded Connection											
3	Three-way											
Actuator Force												
A: 500N	B: 1000N											
C: 1800N												
Fluid Medium W: Water												
Size												
015-DN15	020-DN20											
025-DN25	032-DN32											
040-DN40	050-DN50											
065-DN65	080-DN80											
Pressure Class												
	PN16											
Body Material												
	Stainless Steel											

◆ Installation

The valve must be installed vertically. The direction of the arrow head on the valve body should be in line with the flow direction. As for the electronic actuator, its wiring should be correct, and it cannot be exposed to water.

Installation Dimensions:

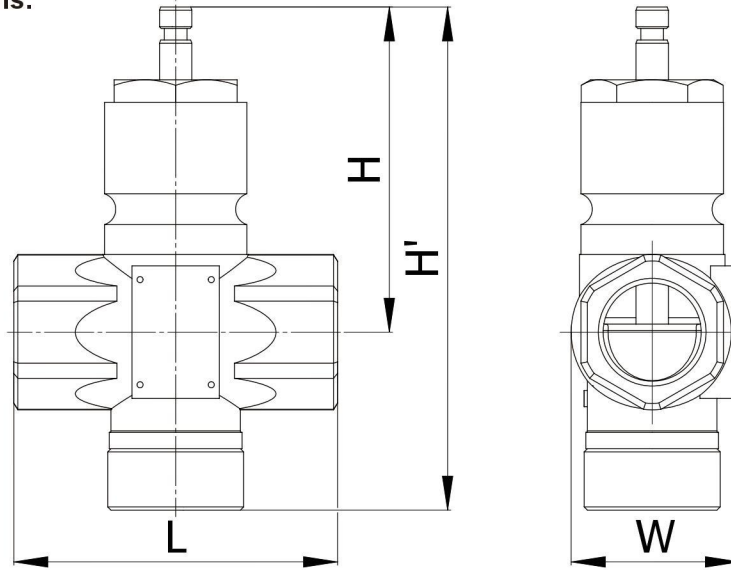

Size	L(mm)	H(mm)	H'(mm)	W(mm)	H+Actuator(mm)	Weight(Kg)
DN15	80	95	144	44	333	0.8
DN20	80	98	149	44	336	1.1
DN25	100	101	156	53	339	1.6
DN32	103	107	169	60	345	1.8
DN40	122	113	184	70	351	2.3
DN50	138	118	203	82	356	3.3
DN65	160	128	228	102	366	6
DN80	180	135	250	125	373	7.1

Valve Body Flow Graph:

DN15-DN80	Mixing Connection	Diverting Connection
Valve Stem Retracting	Flow A increases, and Flow B decreases.	Flow A increases, and Flow B decreases.
Valve Stem Extending	Flow A decreases, and Flow B increases.	Flow A decreases, and Flow B increases.